

**HORIZONTAL SECTIONAL DETAIL**

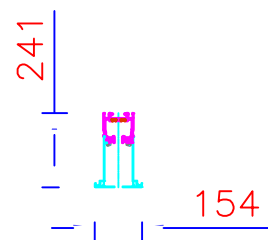

**COMFORTDRIVE TRACK DETAIL**

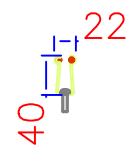

**FLOOR TRACK DETAIL**

**150** FIXING THE TRACK  
**PARKING AREA EVERY: ≤ 400**  
**AXIS EVERY: ≤ 800**

**SECTIONAL DETAILS OF DORMA MOVEO SOLID COMFORTDRIVE OPERABLE WALL**

**SUSPENSION HEIGHT=**  
**MIN.400~MAX.1000**  
**OPENING HEIGHT Confirm On Site**

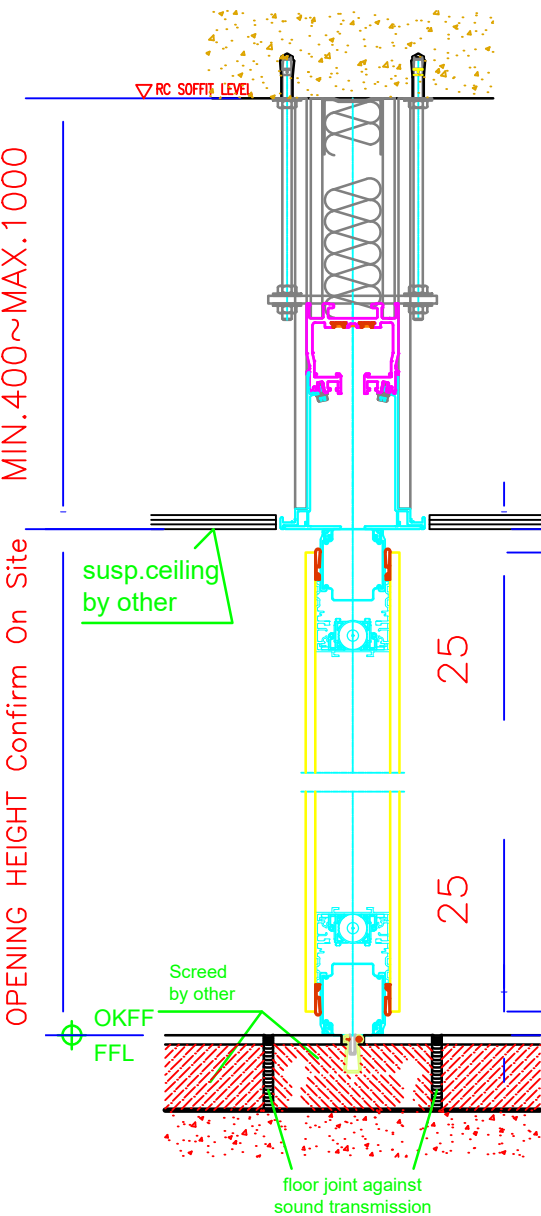

**VERTICAL SECTIONAL DETAIL**

The floor has to adapted to the floor guide.  
 Don't press the floor guide together!  
 By polygon walls the tolerance of the angle is  $\pm 0,5^\circ$ .

**XXX** Functional dimension  
 Tolerance  $\pm 1$  mm  
 These dimensions have to be checked if you order the elements.

**MOVEO ComfortDrive K**

Sound reduction  $R_w$  49dB Weight per  $m^2 = 30$  kg  
 Surface : **TO BE ADVISED!**  
 Weight of the system under unfavourable load concentration to be taken into account or checked in the static analysis.  
 All flanking components must exhibit a sound reduction value of of min.  $R_w$  49 dB.

Attention !  
 Ceiling track to be fixed to static bearing components installed by others!  
 No non-system components may be fixed to or placed on the ceiling track or the lower track casing.  
 The ceiling track must remain dismantlable to allow introduction and suspension of the sliding elements.  
 Following installation of the ceiling track, a total deflection of the building structure of 10 mm is permissible.

Power supply data: 100 - 240V AC / 50 - 60 Hz / min.10A.  
 Control unit connected at 2-pole-and-earth socket.  
 The installation of the Control unit and the key switch is ex works.  
 Connection diagram in the control unit!  
 The control unit must be firmly installed at an easily accessible position close to the parking area.  
 Key switch must be installed in full view of the Wall system!

\* THE PARKING COMPARTMENT SIZE IS BASED ON BARE SURFACE FINISH ONLY.

\* THE SOUND INSULATION VALUES STATED ARE LABORATORY VALUES DETERMINED IN ACCORDANCE WITH DIN EN 20140-3. BECAUSE OF EQUIPMENT VARIANTS, THAT DIFFER FROM THE LABORATORY SETUP, CHANGES OF THE SOUND INSULATION PROPERTIES ARE POSSIBLE. WE CANNOT OFFER ANY GUARANTEE FOR THE SOUND INSULATION VALUES ACHIEVED IN THE AS-INSTALLED CONDITION AS WE HAVE NO INFLUENCE OVER THE ADJACENT COMPONENTS (VENTILATION DUCTS, CABLE SHAFTS, FLOATING SCREED FLOORING, ETC.).

				1 RUN		Project:	
						Generic Comfort Sectional Details	
				Drawn By:	Checked By:	Proposed Layout Wall	
				Gary	Woody	Scale	
				07-06-2024	07-06-2024	NTS	
				Drawing no.:			
				2024.7141.01			
				Rev.			
				0			
Rev.	Date	Drawn	Checked	Requested & Checked	Replacement for		Project No.:
							XXXX