

HORIZONTAL SECTIONAL DETAIL

HORIZONTAL SECTIONAL DETAILS
SCALE 1:4

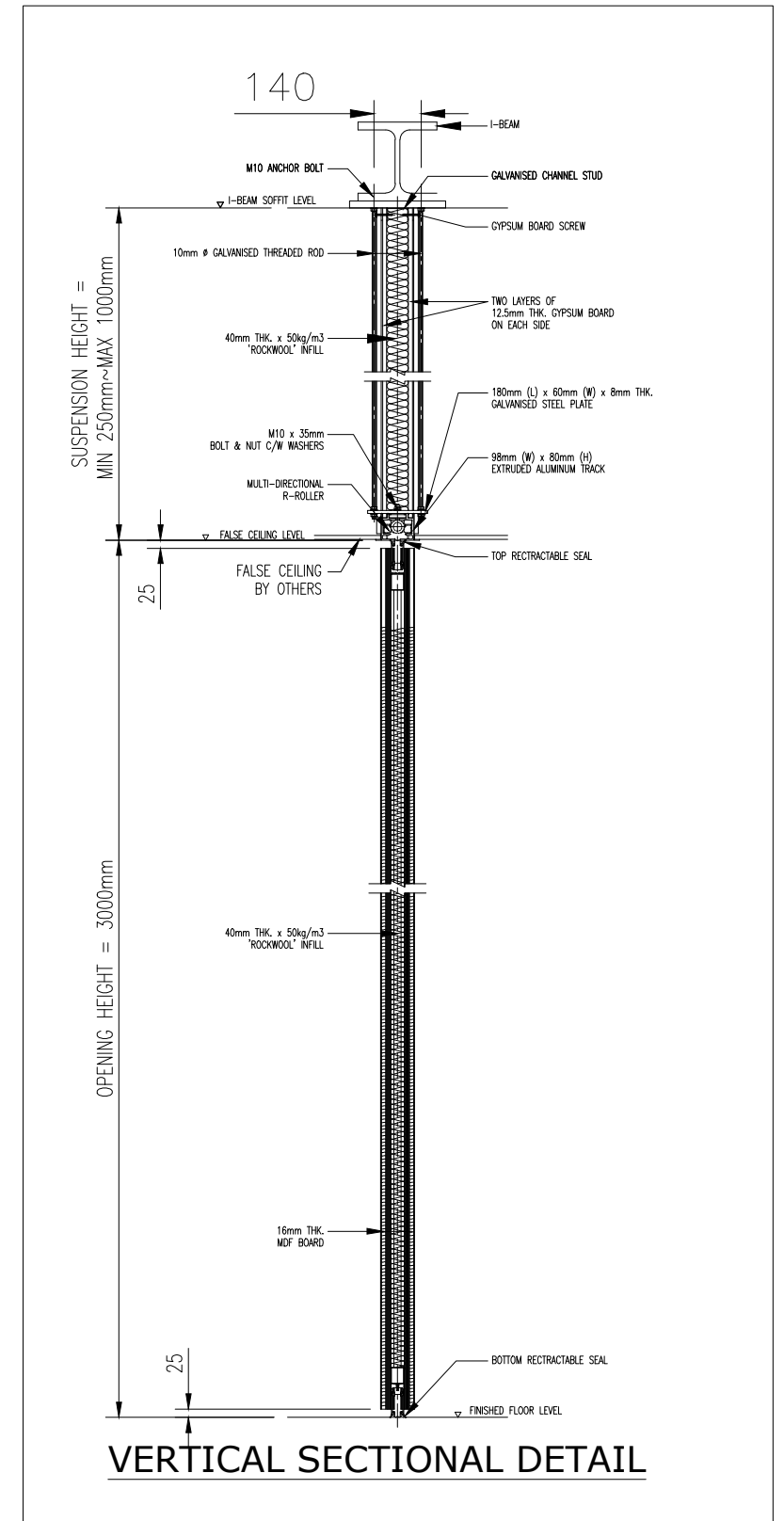

VERTICAL SECTIONAL DETAIL

VERTICAL SECTIONAL DETAILS
SCALE 1:10

VARIFLEX

Type: SOLID 100U, $R_w=55dB^{**}$

Weight per sqm 66kgs. Total weight of operable wall must be considered and checked in statical calculation under unfavourable load conditions.

All flanking building elements must achieve a minimum, sound insulating value of $R_w=55dB^{**}$

Attention : It is not allowed to fix or connect other building parts to our tracks. The track has to remain removable for fixing the elements.

After installation of tracks a 10mm deflection of the building structure has been considered.

* ALL FINAL DIMENSIONS TO BE VERIFY ON SITE PRIOR COMMENCEMENT OF ACTUAL WORKS ON SITE

** THE SOUND INSULATION VALUES STATED ARE LABORATORY VALUES DETERMINED IN ACCORDANCE WITH DIN EN 20140-3. BECAUSE OF EQUIPMENT VARIANTS, THAT DIFFER FROM THE LABORATORY SETUP, CHANGES OF THE SOUND INSULATION PROPERTIES ARE POSSIBLE. WE CANNOT OFFER ANY GUARANTEE FOR THE SOUND INSULATION VALUES ACHIEVED IN THE AS-INSTALLED CONDITION AS WE HAVE NO INFLUENCE OVER THE ADJACENT COMPONENTS (VENTILATION DUCTS, CABLE SHAFTS, FLOATING SCREED FLOORING, ETC.).

DISTANCE BETWEEN TRACK SUSPENSIONS	
PARKING AREA	≤ 400 & 300 mm
MAIN AXIS	≤ 800 mm

				1 RUN		Project: Anthony HARper	
Drawn By: Gary		Checked By: Woody		Date: 20.04.2023		Date: 21.04.2023	
				Drawing no.:		Scale: NTS	
				TRANS-SPACE		Rev. 0	
				MANAGING SPACE WITH OPERABLE WALLS AND DOORS		Replacement for: Project No.: 6504	